

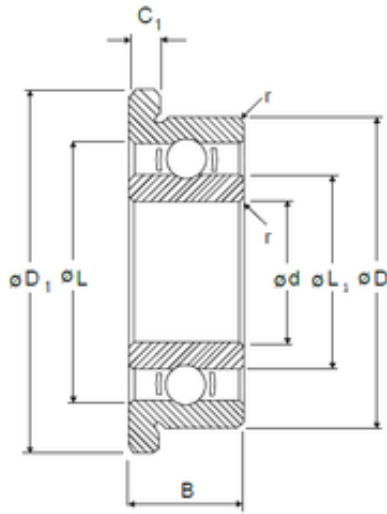

## BEARING PRECISION AXLE CORP.



4 mm x 7 mm x 2 mm NMB LF-740 Deep groove ball bearings

Bearing No. LF-740

Size	4x7x2 mm
Bore Diameter	4 mm
Outer Diameter	7 mm
Width	2 mm
d	4 mm
D	7 mm
B	2 mm
C	2 mm
r min.	0,08 mm
C1	0,6 mm
D1	8,2 mm
L	5,93 mm
L1	4,8 mm
Basic dynamic load rating (C)	0,252 kN

LF-740 Bearing 2D drawings and 3D CAD models