

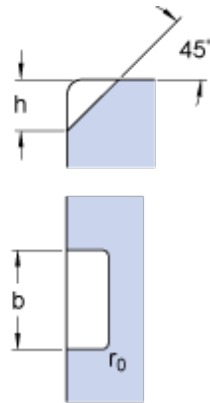

BEARING PRECISION AXLE CORP.

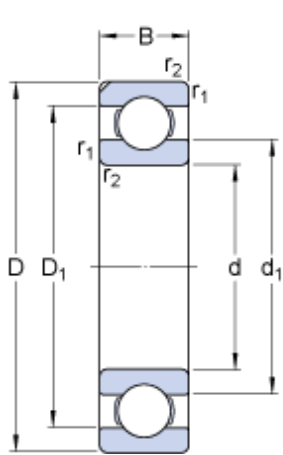

650 mm x 920 mm x 118 mm SKF 306708 D
Deep groove ball bearings

Bearing No. 306708 D

306708 D Bearing 2D drawings and 3D CAD models

Size	920x650x118 mm
Bore Diameter	920 mm
Outer Diameter	650 mm
Width	118 mm
d	650 mm
D	920 mm
B	118 mm
d ₁	737 mm
D ₁	830 mm
h	32 mm
b	20.5 mm
r _{1,2} - min.	6 mm
r ₀	3 mm
d _a - min.	673 mm
D _a - max.	897 mm
r _a - max.	5 mm
Basic dynamic load rating - C	780 kN
Basic static load rating - C ₀	1730 kN
Fatigue load limit - P _u	26 kN
Reference speed	1200 r/min
Limiting speed	1000 r/min
Calculation factor - k _r	0.02
Calculation factor - f ₀	16
d ₁	737 mm



BEARING PRECISION AXLE CORP.

D_1	830.8 mm
r_0	3 mm
$r_{1,2}$ min.	6 mm
d_a min.	673 mm
D_a max.	897 mm
r_a max.	5 mm
Basic dynamic load rating C	780 kN
Basic static load rating C_0	1730 kN
Fatigue load limit P_u	26 kN
Calculation factor k_r	0.02
Calculation factor f_0	16.5
Mass bearing	250 kg