

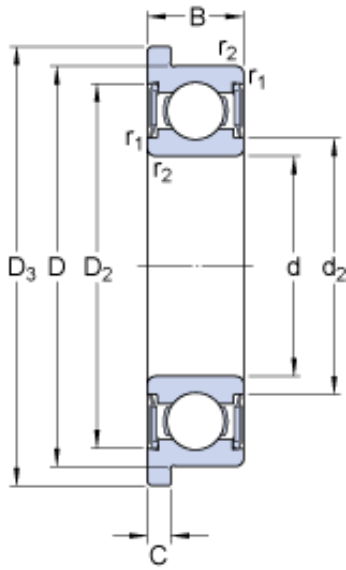

BEARING PRECISION AXLE CORP.



6 mm x 17 mm x 6 mm SKF W 606 R-2RS1 Deep groove ball bearings

Bearing No. W 606 R-2RS1

W 606 R-2RS1 Bearing 2D drawings and 3D CAD models

Size	17x6x6 mm
Bore Diameter	17 mm
Outer Diameter	6 mm
Width	6 mm
d	6 mm
D	17 mm
B	6 mm
d ₂	8.2 mm
D ₂	14.8 mm
D ₃	19 mm
C	1.2 mm
r _{1,2} - min.	0.3 mm
d _a - min.	8 mm
r _a - max.	0.3 mm
Basic dynamic load rating - C	2 kN
Basic static load rating - C ₀	0.83 kN
Fatigue load limit - P _u	0.036 kN
Limiting speed	26000 r/min
Calculation factor - k _r	0.03
Calculation factor - f ₀	11.4
d ₂	8.2 mm
D ₂	14.8 mm
D ₃	19 mm
r _{1,2} min.	0.3 mm



BEARING PRECISION AXLE CORP.

d_a min.	7.7 mm
d_a max.	8.1 mm
r_a max.	0.3 mm
Basic dynamic load rating C	1.95 kN
Basic static load rating C_0	0.83 kN
Fatigue load limit P_u	0.036 kN
Calculation factor k_r	0.03
Calculation factor f_0	11.4
Mass bearing	0.0063 kg