

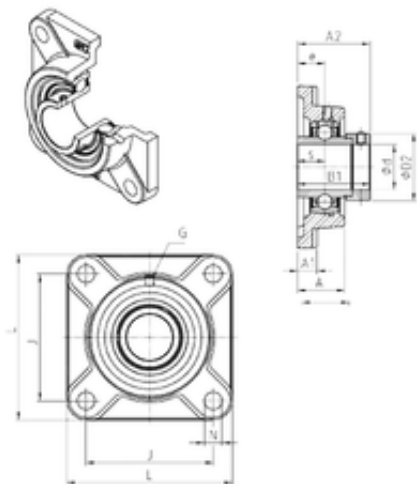

# BEARING PRECISION AXLE CORP.



## SNR EXF312 Bearing units

Bearing No. EXF312

Bore Diameter	60 mm
d	60 mm
e	33 mm
s	31 mm
A	56 mm
A1	22 mm
B1	79,4 mm
D2	89 mm
J	150 mm
L	193 mm
N	23 mm
Thread (G)	M6x1
A2	81,5 mm
Weight	6,7 Kg
Basic dynamic load rating (C)	81,6 kN

EXF312 Bearing 2D drawings and 3D CAD models