

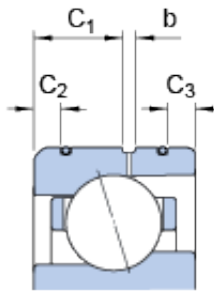

BEARING PRECISION AXLE CORP.

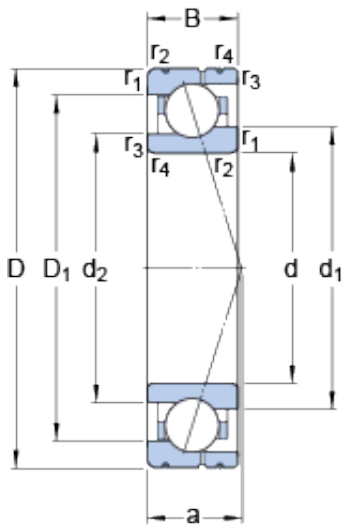

35 mm x 55 mm x 10 mm SKF 71907
ACE/P4AL Angular contact ball bearings

Bearing No. 71907 ACE/P4AL

71907 ACE/P4AL Bearing 2D drawings and 3D CAD models

Size	55x35x10 mm
Bore Diameter	55 mm
Outer Diameter	35 mm
Width	10 mm
d	35 mm
D	55 mm
B	10 mm
d ₁	41.7 mm
d ₂	40.2 mm
D ₁	48.29 mm
b	1.6 mm
C ₁	5.1 mm
C ₂	1.8 mm
C ₃	1.2 mm
r _{1,2} - min.	0.6 mm
r _{3,4} - min.	0.3 mm
a	16.2 mm
d _a - min.	38.2 mm
d _b - min.	37 mm
D _a - max.	51.8 mm
D _b - max.	53 mm
r _a - max.	0.6 mm
r _b - max.	0.3 mm
d _n	43 mm



BEARING PRECISION AXLE CORP.

Basic dynamic load rating - C	7.3 kN
Basic static load rating - C ₀	4.5 kN
Fatigue load limit - P _u	0.19 kN
Limiting speed for grease lubrication	32000 r/min
Limiting speed for oil lubrication	50000 mm/min
Ball - D _w	5.556 mm
Ball - z	19
G _{ref}	0.8 cm ³
Calculation factor - e	0.68
Calculation factor - Y ₂	0.87
Calculation factor - Y ₀	0.38
Calculation factor - X ₂	0.41
Calculation factor - Y ₁	0.92
Calculation factor - Y ₂	1.41
Calculation factor - Y ₀	0.76
Calculation factor - X ₂	0.67
Preload class A - G _A	66 N
Preload class B - G _B	200 N
Preload class C - G _C	400 N
Calculation factor - f	1.05
Calculation factor - f ₁	0.99
Calculation factor - f _{2A}	1
Calculation factor - f _{2B}	1.04
Calculation factor - f _{2C}	1.07
Calculation factor - f _{HC}	1
Preload class A	69 N/micron
Preload class B	104 N/micron



BEARING PRECISION AXLE CORP.

Preload class C	136 N/micron
d_1	41.7 mm
d_2	40.2 mm
D_1	48.29 mm
C_1	5.1 mm
C_2	1.8 mm
C_3	1.2 mm
$r_{1,2}$ min.	0.6 mm
$r_{3,4}$ min.	0.3 mm
d_a min.	38.2 mm
d_b min.	37 mm
D_a max.	51.8 mm
D_b max.	53 mm
r_a max.	0.6 mm
r_b max.	0.3 mm
d_n	43 mm
Basic dynamic load rating C	7.28 kN
Basic static load rating C_0	4.5 kN
Fatigue load limit P_u	0.19 kN
Attainable speed for grease lubrication	32000 r/min
Attainable speed for oil-air lubrication	50000 r/min
Ball diameter D_w	5.556 mm
Number of balls z	19
Reference grease quantity G_{ref}	0.8 cm ³
Preload class A G_A	66 N
Static axial stiffness, preload class A	69 N/ μ m
Preload class B G_B	200 N
Static axial stiffness, preload class B	104 N/ μ m
Preload class C G_C	400 N



BEARING PRECISION AXLE CORP.

Static axial stiffness, preload class C	136 N/ μ m
Calculation factor f	1.05
Calculation factor f_1	0.99
Calculation factor f_{2A}	1
Calculation factor f_{2B}	1.04
Calculation factor f_{2C}	1.07
Calculation factor f_{HC}	1
Calculation factor e	0.68
Calculation factor (single, tandem) Y_2	0.87
Calculation factor (single, tandem) Y_0	0.38
Calculation factor (single, tandem) X_2	0.41
Calculation factor (back-to-back, face-to-face) Y_1	0.92
Calculation factor (back-to-back, face-to-face) Y_2	1.41
Calculation factor (back-to-back, face-to-face) Y_0	0.76
Calculation factor (back-to-back, face-to-face) X_2	0.67
Mass bearing	0.075 kg